

YOYO Cam™
 QUICK START GUIDE
 YOYO Cam 3G Indoor
 Model G33
 GSM/3G Remote Surveillance Camera

YOYO Cam G33 Status Indicator

LED	Status
	Searching for network / SIM PIN lock enabled
	Alarm triggered
	No SIM card / System error / charging (power switch off)
	Arming (20seconds to armed state)
	Armed
	Disarmed / Waiting for Master to register
	Sending messages / Ongoing voice call
	Factory reset

Key	Indicator	Description
		Fast flash (two flashes per second)
		Slow flash (one flash per second)
		Two second flash
		Two quick flashes every 2 seconds
		On

Note: Send #31#0# to disable status indicator LED, #31#1# to enable it (default).

A3 Rev G

© Copyright, February 2017, Yoyomotion AB. All rights reserved.

YOYO Cam G33 Features

Insert a SIM card, perform a few simple configuration steps and YOYO Cam is ready to guard your property.

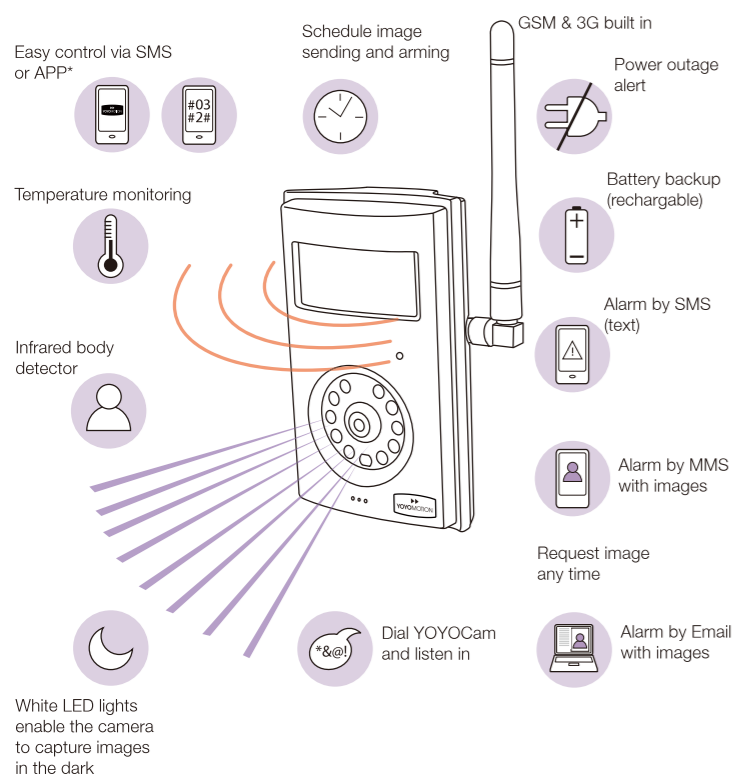

*Search for YOYO Cam 3G Indoor on the App Store™ or Google Play™

Get to know YOYO Cam G33

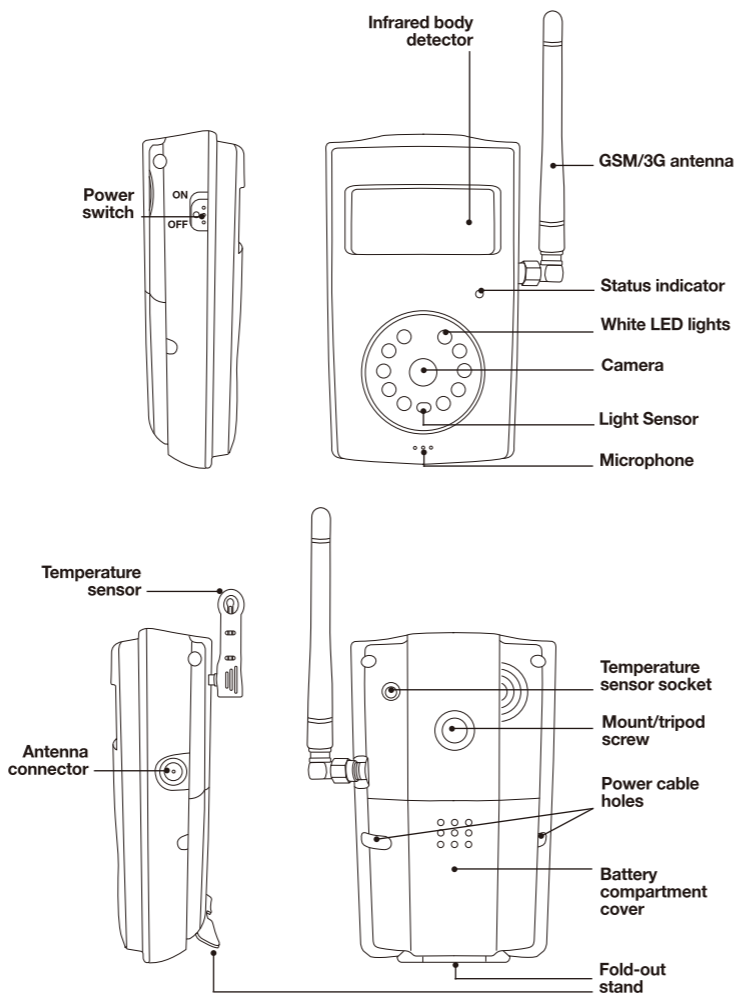

Built in Stand

Un-clip the stand and rotate backwards.

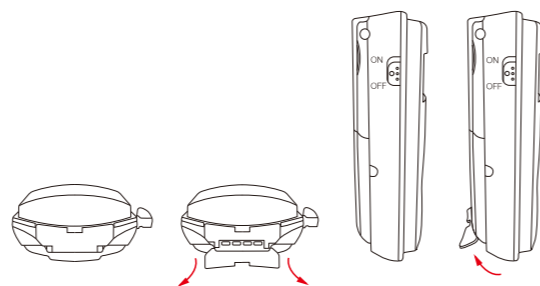

Mounting Bracket

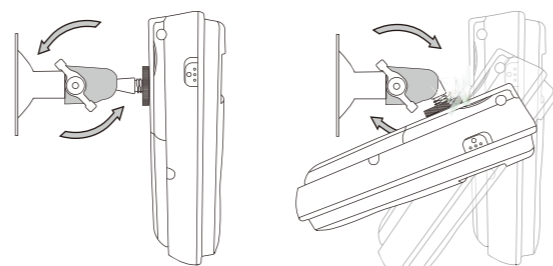

STEP 1. Prepare YOYO Cam G33

1. To attach the antenna, align the plug with the antenna connector and screw it on gently by hand until it is finger tight. Do not use tools. To remove it, gently unscrew the nut by hand.

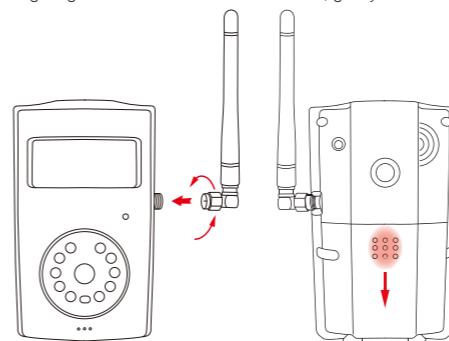

2. Press gently on the raised dots and slide the cover downwards.
 3. Lift the battery cover away from the device.

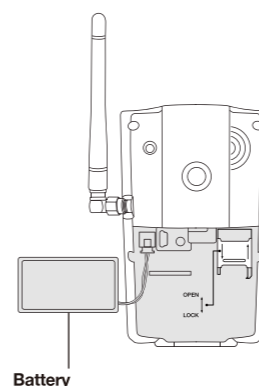

4. Move the battery out of the way as shown.
 5. Insert the SIM card as indicated in the picture below.

- NOTE:** The SIM PIN must be disabled. Use a mobile phone to check and, if necessary, turn off SIM Lock.
- NOTE:** Check that the SIM card has credit and is enabled for MMS and mobile internet.

WARNING: Always be sure to switch off YOYO Cam and disconnect the power before inserting or removing the SIM card. Do not touch the gold contacts of the SIM Card.

- Slide the clip upwards in the direction of the OPEN arrow (1).
- Lift the clip (2).
- Locate the SIM card in the holder, gold contacts facing down. Be careful not to push the SIM card past the clip so that it ends up inside YOYO Cam.
- Close the metal clip (3).
- Slide the clip downwards (4) in the direction of the LOCK arrow.

TIP: Pressing lightly on each side of the metal clip makes it easier to click open and shut.
 YOYO Cam uses a standard size SIM Card (not micro or nano size)

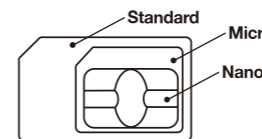

6. Insert the power connector and lead the power cable out to the left or right, as required.
 7. Replace the battery. Locate the back cover as shown. Press upwards at the two points indicated (not in the centre) to click it in to place.
 8. Plug in the temperature sensor, if required. Use a standard 3.5mm stereo audio extension cable if you wish to locate the sensor away from YOYO Cam.

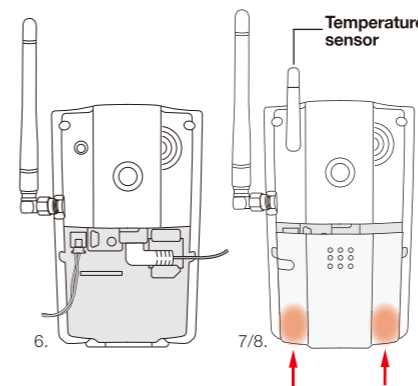

STEP 2. Mount YOYO Cam G33

BUILT IN STAND
 Un-clip the stand and rotate backwards. See illustration opposite.

MOUNTING BRACKET

- Mount the bracket on the wall, ceiling or other surface as required.
- Attach YOYO Cam to the threaded tip of the bracket.
- Screw the round lock-nut towards YOYO Cam to secure YOYO Cam on the mount.
- Loosen the screw so that the angle can be adjusted. (See illustration opposite).
- Tighten the screw to fix YOYO Cam in the desired position.

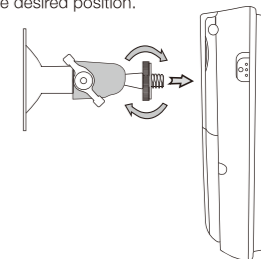

STEP 3. Set Up YOYO Cam G33

- Plug the power adaptor in to an outlet.
- Slide the power switch to the ON position to turn on YOYO Cam.
- After approximately 60 seconds, YOYO Cam bleeps to indicate that the mobile network has been found.
- From your mobile phone, send an SMS with text #00# to the mobile number of YOYO Cam's SIM card. YOYO Cam confirms your phone as Master by SMS, meaning that you have full control over YOYO Cam.
- The SMS responses are in Swedish by default.
 Send #36#1# to switch to English.
- Arm YOYO Cam
 - Send an SMS with text #01# to arm YOYO Cam
 - Send an SMS with text #02# to disarm YOYO Cam

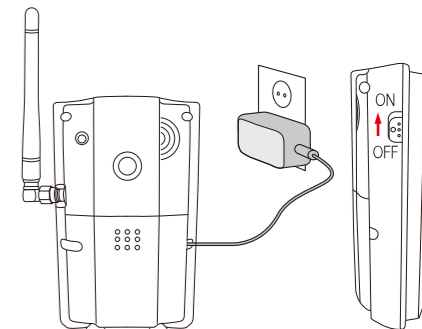

YOYO Cam is now operational.

In the armed state, YOYO Cam raises an alarm when the built-in infrared body sensor detects movement. When the alarm is raised, YOYO Cam sends an SMS to the Master followed by an MMS with images. Alternatively, the images can be sent to pre-set E-mail addresses or YOYO Cam can make a call to pre-set telephone number. Image and alarm settings can be configured – see *Using YOYO Cam G33* and *Complete Command List*.

Using YOYO Cam G33

The easiest way to drive YOYO Cam is to install our app *YOYO Cam 3G Indoor* from the App Store™ or Google Play™. You can also drive YOYO Cam from any kind of mobile phone via SMS commands.

The default Password is 1234. Change the Password to your own 4-digit number, for example:

- #18#1234#0678# changes the default Password to 0678

As Master, you can add up to 4 Users who can arm/disarm YOYO Cam and request images:

- #07#UserNumber# adds UserNumber, for example #07#+46701234567#
- #27#UserNumber# deletes UserNumber

Master and Users may arm and disarm YOYO Cam:

- #01# arms YOYO Cam. Infrared body sensor is activated after a 20 second delay is received.
- #02# disarms YOYO Cam. Infrared body sensor is turned off.

Master and Users can request an image to be sent using MMS:

- #03# sends the MMS to the requestor (Master or User)
- #03# Number# sends the MMS to Number (does not need to be a User)
- Default image quality is High (1280 x 768)

Master and Users can call YOYO Cam and listen in via the built-in microphone.

- The caller must send (i.e. not withhold) the mobile number on voice calls. YOYO Cam rejects withheld and unknown numbers with busy-tone.

Users do not receive alarms by default. The Master can enable alarms to users:

- #32#1# enables SMS alarm to Users; #32#0# turns it off
- #33#1# enables alarm images to Users; #33#0# turns it off
- By default YOYO Cam sends 3 images at High quality (1280 x 768) using MMS.

YOYO Cam automatically configures MMS settings for most networks in Scandinavia, Germany, and Spain. Settings for other networks can be configured manually. Data service and Data roaming are by default off.

To send images using Email, YOYO Cam must be configured with settings for Internet, Email sender address and Email Server. The simplest way is to create a new Gmail or Outlook.com account for YOYO Cam, then send the Email address and password:

- #62#gmail#EmailAddress#Password# for a Gmail account.
- #62#outlook#EmailAddress#Password# for an Outlook.com or Hotmail account.

You may need to additionally go in to the account settings for the Gmail or Outlook.com account and enable SMTP.

For other Email services, please ask your provider for the parameters needed to send Email:

- #26#SenderAddress#Password#SMTPserverAddress #SMTP-port#SSL#TLS#

Note that SenderAddress might be a username. SMTP-port is usually 25, 465 or 587. SSL and TLS take values 0 (OFF) or 1 (on).

YOYOCam G33 - Complete Command List

Note: CAPITALS (eg. OFF) denote default setting

ARM AND DISARM (Master & User)

Arm (active 20 seconds after command received)	#01#
Disarm	#02#

GET IMAGE (Master & User)

Capture & send back to me by MMS	#03#
Capture & send to Number by MMS	#03#Number#
Capture & send to Master Email	#05# (Sent by Master)
Capture & send to Master Email and User Email List	#05# (Sent by User)
Capture & send to EmailAddress	#05#EmailAddress#

DEFINE MASTER

Set me as Master (out of box / after factory reset)	#00#
Master - transfer to a new phone number	#14#NewMasterNumber#
Set/update Master's Email address	#09#EmailAddress#
Delete Master's Email address	#09#

DEFINE USERS

Add User (UserNumber = User's mobile number)	#07#UserNumber#
Add Email to User Email List	#07#EmailAddress#
Delete User	#27#UserNumber#
Delete all Users and User Email List	#27#
Change Password	#18#OldPassword#NewPassword#

ALARM NOTIFICATIONS

Warning tone upon alarm - OFF	#30#0#
Warning tone upon alarm - on	#30#1#
SMS alert upon alarm - off	#11#0#
SMS alert upon alarm - ON	#11#1#
Message upon alarm - off	#12#0#
MMS upon alarm – ON	
(Contains images as per <i>IMAGE SETTINGS</i> below)	
Email upon alarm – off	
(Contains images as per <i>IMAGE SETTINGS</i> below)	
	#12#2#
Telephone call at Alarm - OFF	#13#0#
Telephone call at Alarm - on	#13#1#
SMS to Users - OFF	#32#0#
SMS to Users - on	#32#1#
Message to Users - OFF	#33#0#
Message to Users – on	
(Contains images as per <i>IMAGE SETTINGS</i> below)	
(MMS to Users or Email to User Email List, with images, as set by #12# above)	#33#1#

TEMPERATURE SENSOR

Get temperature from plug-in sensor	#15#
Set temperature range to monitor	#16#LoTemp#HiTemp#
Temperature alert - OFF	#15#0#
Temperature alert - on	#15#1#

SCHEDULED ACTIONS

Scheduled arm/disarm - setting	#41#Day#ArmTime#DisarmTime#
Scheduled arm/disarm - OFF	#04#0#
Scheduled arm/disarm - on	#04#1#
Scheduled image capture & send - setting	
Mode: 0 - Email; 1 - MMS	#43#Mode#Day#StartTime#EndTime#Interval#
Scheduled image capture & send - OFF	#06#0#
Scheduled image capture & send - on	#06#1#

Day: 0 - Every day; 1 - Mon; 2 - Tue; 3 - Wed; 4 - Thu; 5 - Fri; 6 - Sat; 7 - Sun; 8 - Mon-Fri; 9 - Weekend (Sat+Sun)

IMAGE SETTINGS

Number of images in alarm message (1 to 5); default 3	#21#Quantity#
Size of image in alarm, get image or scheduled capture & send. Quality 1: Low (320 x 240), 2: Medium (800x480), 3: High (1280 x 768)(default)	#22#Quality#

LED LIGHTING SETTINGS

off (never turned on)	#20#0#
AUTO mode (on when dark and motion detected)	#20#1#
Always (on whenever motion detected, even in bright light)	#20#2#

GET STATUS

Get status	#10#
Technical status report (firmware version, IMEI, signal)	#40#

ADVANCED SETTINGS

Infrared body detector - off	#17#0#
Infrared body detector - ON	#17#1#
LED status indicator - off	#31#0#
LED status indicator - ON	#31#1#
Power change notification SMS - off	#35#0#
Power change notification SMS - ON	#35#1#
Language – English	#36#1#
Language – SWEDISH	#36#2#
Weak signal alert by SMS – OFF	#37#0#
Weak signal alert by SMS – on (requires enough signal to send an SMS)	#37#1#
Forward SMS from unknown numbers to Master – ON	#50#0#
Forward SMS from unknown numbers to Master – off	#50#1#
Auto disarm after repeated alarms – OFF	#55#0#
Auto disarm after n alarms – on	#55#n#

CONFIGURE EMAIL SERVICE

Check Email parameters	#26#
Configure Email sending parameters (Gmail)	#62#gmail#EmailAddress#Password#
Configure Email sending parameters (Outlook.com, Hotmail)	#62#outlook#EmailAddress#Password#
Configure Email sending parameters (other)	#26#SenderAddress#password#SMTPserver#SMTP port#SSL#TLS#

Note: Internet service must also be configured to be able to send Email.

CONFIGURE MMS AND INTERNET SERVICE

YOYOCam automatically configures MMS settings for most networks in Scandinavia, Germany, and Spain. Settings for other networks can be configured manually. Data service and Data roaming are by default off.

MMS - get current setting	#25#
MMS - manual setting	#25#MMSC#MMSProxyIP#MMSProxyPort#MMSProxyPort2#APN#UserName#Password#APNType#
MMS - AUTOMATIC setting	#54#
DATA - get current setting	#24#
DATA - OFF	#24#0#
DATA - manual setting	#24#APN#UserName#Password#MCC#MNC#DataProxyIP#DataProxyPort#APNType#
DATA - automatic setting	#24#1#
Data-roaming - current setting	#48#
Data-roaming - OFF	#48#0#
Data-roaming - on	#48#1#

RESET

Remote restart (reboot)	#42#password#
Factory reset (wipes all settings and data except wireless sensors and remotes).	#19#Password#

Factory Reset

If the Master phone is lost or you want to set up YOYOCam again from the beginning, you can use Factory Reset to set all settings and parameters back to the factory default. Following Factory Reset you will need to set the Master user, re-enter any mobile network(MMS, Email) settings and reconfigure all users etc. To perform Factory Reset:

- Make sure YOYOCam is switched on, status ● armed or ✖ disarmed.
- Press and hold the Reset key for 5 seconds until YOYOCam beeps.
- You may now release the Reset key. Factory Reset is complete.

Alternatively, the Master can send #19#Password#

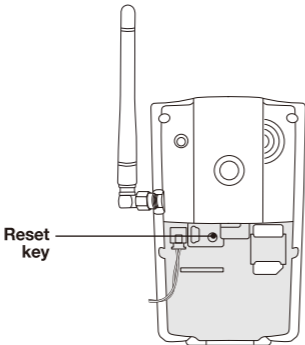

YOYOCam G33 Troubleshooting Guide

The status indicator is off

The back-up battery is flat or not connected and there is no external power.

- Check the battery connection and connect power

The status indicator stays on slow red blink ✖

The SIM-card in YOYOCam has the PIN-lock enabled.

- Place the SIM card in a mobile phone to check and if necessary switch off PIN-lock

YOYOCam is out of reach for mobile network coverage.

- Try YOYOCam in different positions for better signal strength, or use a high-gain external antenna with extension cable.

There is no SIM-card or it is not properly inserted.

- Check that the SIM card is inserted according to the instructions in STEP 1.

The SIM-card is inactive (expired, locked, not yet activated ...).

- Check the SIM card in a mobile phone and contact your mobile operator if necessary

The status indicator is on green blink ✖ but YOYCam responds that a password is required or that you are not valid user

YOYOCam has not yet got a registered Master.

- See *STEP3 Setup YOYOCam G33*

You are not the registered Master or a registered User.

- See *Using YOYOCam G33* to set up Users or change the Master

SMS-messages but no MMS or Email or images are received from YOYOCam.

YOYOCam was disarmed (by SMS, Remote orAPP) too quickly after detection / SMS notification and the MMS or Email transmission was interrupted.

- Allow more time (until the status indicator has stopped blinking) before disarming

The SIM-card does not have MMS service activated at delivery.

- Easily done by sending an activation-SMS from a regular mobile phone with the SIM-card inserted.
- Consult the homepage or contact your mobile operator.

The SIM-card is from a mobile operator for which YOYOCam does not know the settings.

- Get current MMS settings with #25#
- Set up MMS manually. See Mobile Network Settings section of the User Guide.

YOYOCam has been set up with manual MMS settings but they are wrong

- Get current settings by sending #25# to your YOYOCam's mobile number. Compare with the settings required for your mobile operator.
- Use #25# with parameters to correct the settings

Poor GSM/3G coverage. Signal strength is enough for SMS, but not for MMS, or Email.

- Relocate YOYOCam to a place with better coverage
- Try a SIM-card from another mobile operator
- Use a high-gain external antenna with extension cable

Your mobile operator's MMS service cannot handle large images

- Reduce image size, for example send #22#2# to reduce it to 640x480 pixels

Email messages are not being received from YOYOCam

Email requires additional settings and mobile Internet service.

- (has never worked) Check that the Email account and server settings are correct
- Ensure that Email addresses are no longer than 33 characters
- Check that the SIM card has Mobile Internet service (put SIM in a smartphone and check web browsing works)
- Check that the Mobile Internet settings are correct

Master receives SMS “External power lost...” followed by a new SMS “External power, resumed”

AC power was temporarily cut. This can sometimes be caused by electrical machinery or heating switching on or off, and getting detected by YOYOCam.

- This has no functional impact on YOYOCam. The built-in back-up battery keeps it running.
- The SMS power notifications can be switched off by sending #35#0# to your YOYOCam's mobile number.

Master receives SMS saying that an incoming message is being forwarded.

Incoming SMS from unregistered users are forwarded to the Master. This is a security precaution in case someone is trying to access YOYOCam. This function is also useful if operators notify when the credit is low.

The forwarding function can be turned off by sending #50#0# to your YOYOCam's mobile number.

Master and/or User receives alarm images but there is no visible cause for the alarm

The built-in IR-sensor of YOYOCam senses temperature variations within it's scan field, e.g. a human body (37°C) that moves in a room (18-20°C). IR-sensors can not distinguish a human from other fields of deviating temperature (even invisible ones) that move around. Therefore, an alarm may be raised due to invisible sources of heat or cold (e.g. a radiator, furnace, stove, heater, air condition, lamps, draughts, floor heating, door gaps, ventilators etc.) that cause temperature variations in the scan field of the IR- sensor.

YOYOCam does not raise an alarm when a human moves in front of it

The IR-sensor's ability to detect human motion is reduced if the surrounding room temperature is similar to that of the human. Movements from the side, across the scan area are easier to detect than movements coming straight toward the sensor. IR-sensors operate better mounted at 2 meters above the floor. Mounted lower or higher may reduce it's ability to detect human motion.

Important Information

Please read this information before using your YOYOCam.

Safety and Usage Guidelines

- Read the terms and conditions for your SIM card and mobile operator service.
- When inserting or removing the SIM card, do not touch the gold connectors.
- Use only the approved YOYOMotion AC power adaptor for YOYOCam G33.
- Treat your YOYOCam carefully; store it safely and do not drop or throw it.
- Do not expose your YOYOCam to dust, liquid, moisture or humidity.
- Do not use or store your YOYOCam at extreme high or low temperatures.
- Do not expose your YOYOCam to naked flames, lit tobacco products or other heat sources.
- Do not use your YOYOCam in hospitals or near medical equipment.
- If you have personal medical devices such as a pacemaker, consult your physician and the manufacturer for advice.
- Do not use your YOYOCam in aircraft or in any place where use of radio transmitters is prohibited.
- Do not use your YOYOCam in places where a potentially explosive atmosphere is present.
- Do not use YOYOCam in proximity to car airbags.
- Do not attempt to take your YOYOCam apart; there are no user-serviceable components inside the product.
- Do not allow children to play with your YOYOCam; small parts such as SIM cards could be detached and represent a choking hazard.
- For optimum performance do not cover your YOYOCam; position it with good access to the mobile signal.
- You should not rely on any voice call capability that your YOYOCam provides for emergency or essential communications.

Battery

- Battery performance (device runtime) depends on signal strength, temperature, usage pattern and other factors.
- The battery may have temporarily reduced capacity when new or after a prolonged period without use.
- Turn off the device and unplug the power adaptor before removing or inserting the battery.
- Do not allow the battery contacts to touch any metal object or other conductor.
- Use only the supplied battery or accessory/service replacement battery from YOYOMotion.

Disposal and Recycling

- Do not dispose of your YOYOCam with normal household waste.
- Dispose of your YOYOCam at an appropriate collection point for electronic equipment.
- For more information, contact your local authority, your household waste collection depot or the retailer where you bought your YOYOCam.

EU Regulatory Conformance

English: We fulfil the requirements of the R&TTE Directive (99/5/EC). **Česky:** Výrobek splňuje požadavky směrnice R&TTE (99/5/EC). **Dansk:** Vi opfylder kravene i R&TTE-direktivet (99/5/EC). **Deutsch:** Die Anforderungen der Richtlinie für Funk- und Fernmeldegeräte (99/5/EG) werden erfüllt. **Español:** Cumplimos los requisitos de la Directiva R&TTE (99/5/EC). **Français:** Ce produit est conforme à la directive R&TTE (99/5/EC). **Hrvatski:** Mi ispunjavamo zahtjeve R&TTE Direktive (99/5/EC). **Italiano:** Il prodotto soddisfa i requisiti della Direttiva R&TTE (99/5/EC). **Magyar:** Teljesítjük az R&TTE irányelv (99/5/EC) követelményeit. **Nederlands:** We voldoen aan de vereisten die in de R&TTE-richtlijn (99/5/EG) worden gesteld. **Norsk:** Vi oppfyller kravene i R&TTE-direktivet (99/5/EC). **Polski:** Spełniamy wymagania dyrektywy R&TTE (99/5/AWE). **Português:** São cumpridos os requisitos da Directiva R&TTE (99/5/EC). PB Atendemos aos requisitos da Diretriz R&TTE (99/5/EC). **Română:** Îndeplinim cerințele directivei R&TTE (99/5/EC). **Slovenčina:** Výrobok spĺňa požiadavky smernice R&TTE (99/5/EC). **Suomi:** Täytämme radio- ja telepäätelaitedirektiivin (99/5/EY) asettamat vaatimukset. **Svenska:** Vi uppfyller kraven i R&TTE-direktivet (99/5/EC). **Ελληνικά:** Πληρούμε τις απαιτήσεις της Οδηγίας R&TTE (99/5/EK).